



DOCUMENT CHANGE REQUEST

DCR number 368

Changes required for: N/A

Originator: Jean-Laurent BOUTEAUX

Date: 2007/07/25

Date sent: 2007/07/25

Organisation:

Status: IMPLEMENTED

Title: Lightweight accessories for rectangular connectors 3401/001 and 3401/002

Number: 3401/072

Issue: 2

Other documents affected:

Page:

page 16

Paragraph:

page 16

Original wording:

Proposed wording:

Modification of the design of the castellated backshell variant 41 to 45

Justification:

Modification requested by CNES

Attachments:

DCR_368.PDF, null

Modifications:

Delete the original drawing attachment and replace by the latest version of the new Figure 2(h) for Variants 41 to 45 dated 06/02/2008, that includes various missing Dimensions and some editorial amendments (see attached)

Approval signature:

Date signed:

2007-07-25



DOCUMENT CHANGE REQUEST

		Date DCR Received	2007-07-13
Originator	Jean-Laurent BOUTEAUX		DCR Number Number not yet assigned
Affiliation	ESCC chief inspector		
<i>- DOCUMENT</i>			
Doc. No. 3401 072	Issue Issue 2	Title Lightweight Accessories for rectangular connectors 3401/001 end 3401/002	
Paragraphs and Pages Affected		page 16	
Other Documents Affected		No	
Proposed Wording of Change Modification of the design of the castellated backshell variant 41 to 45			
Justification Modification requested by CNES			
Changes req. for N/A	Attachments No	Approval Signature	Date Signed
Approved wording if different from 'Proposed Wording' above or reason for rejection			

ESCC Detail Specification

Page 16

N°3401/072

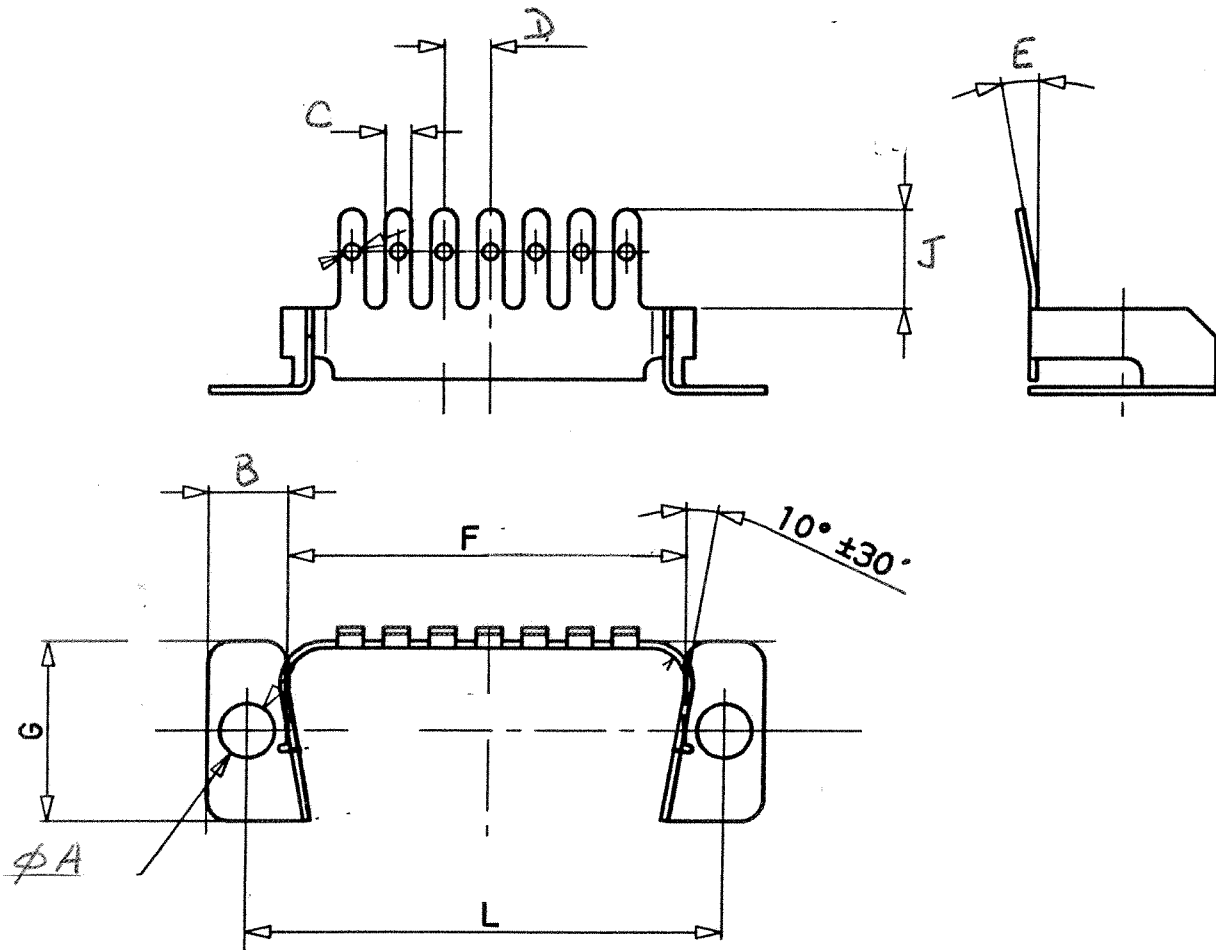

SHELL SIZE	VARIANT	dia A		B		C		D		Nbr of plate	E	
		MIN.	MAX.	MIN.	MAX.	MIN.	MAX.	MIN.	MAX.		MIN.	MAX.
E	41	3,7	3,9	5,25	5,45	1,7	1,9	3,1	3,3	5	10	15
A	42	3,7	3,9	5,25	5,45	1,7	1,9	3,1	3,3	7	10	15
B	43	3,7	3,9	5,25	5,45	1,7	1,9	3,1	3,3	11	10	15
C	44	3,7	3,9	5,25	5,45	1,7	1,9	3,1	3,3	16	10	15
D	45	3,7	3,9	5,25	5,45	1,7	1,9	3,1	3,3	15	10	15

SHELL SIZE	VARIANT	F		G		J		L	
		MIN.	MAX.	MIN.	MAX.	MIN.	MAX.	MIN.	MAX.
E	41	19,45	19,75	12,6	12,8	6,8	7,2	24,86	25,12
A	42	27,7	28	12,6	12,8	6,8	7,2	33,19	33,45
B	43	41,35	41,65	12,6	12,8	6,8	7,2	46,91	47,17
C	44	57,95	58,25	12,6	12,8	6,8	7,2	63,37	63,63
D	45	55,6	55,9	15,3	15,5	6,8	7,2	60,98	61,24

Notes

1. All dimensions are in millimeters.